

INOXMARE®

HEXAGON SOCKET BUTTON HEAD SCREWS, FULL THREAD



DATASHEET
ART. 7380

YOUR ACCESS TO SUCCESS

ART. 7380

TECHNICAL SPECIFICATIONS

Button head screws, sometimes also called half round head screws are frequently used fasteners, as they have a visually attractive head which also has no corners or edges. We keep our stock in SIMILAR ISO 7380-1 only in full thread and without head marking. With head marking and/or partial thread is available on request.

Please note that this article is a screw with reduced load capacity due to your head geometry. According to DIN 3506-1 / ISO 7380-1 the minimum load capacity is 80% of the strength class.

Material	Stainless Steel
Quality	A2 / A4
Property class	050 / 070
Surface	blank
Tolerances	ISO 4759-1
Mechanical properties	ISO 3506-1
Measurement letters and notations	ISO 225
Thread tolerance class	6g
Thread according to	ISO 965-1
General requirements	ISO 8992
Drive	Hexagon socket
Features	Full thread
Headmarking	without

YOUR ADVANTAGES



WITHOUT HEAD MARKING

› Better optics – decorative head

WE'LL BE PLEASED TO ADVISE FOR YOUR APPLICATION.

DIMENSIONS (MM)

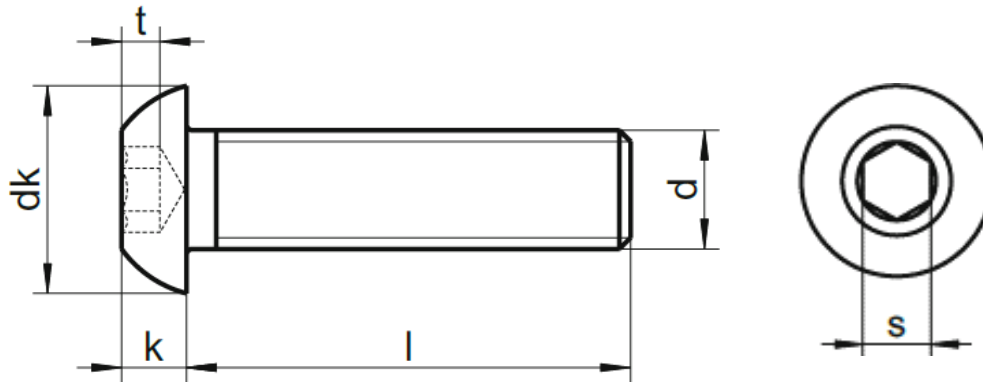

Thread d			M3	M4	M5	M6	M8	M10	M12
dk	min.		5,40	7,24	9,14	10,07	13,57	17,07	20,48
	max.		5,70	7,60	9,50	10,50	14,00	17,50	21,00
k	max.		1,40	1,95	2,50	3,00	4,10	5,20	6,24
	min.		1,65	2,20	2,75	3,30	4,40	5,50	6,60
t	min.		1,04	1,30	1,56	2,08	2,60	3,12	4,16
s	nominal		2	2,5	3	4	5	6	8
Length l			M3	M4	M5	M6	M8	M10	M12
Nominal	min.	max.							
4	3,80	4,20							
5	4,80	5,20							
6	5,76	6,24						too short lengths	
8	7,71	8,29							
10	9,71	10,29							
12	11,65	12,35							
16	15,65	16,35							
20	19,58	20,42							
25	24,58	25,42							
30	29,58	30,42							
35	34,50	35,50							
40	39,50	40,50							
45	44,50	45,50							
50	49,50	50,50							
60	59,40	60,60							
70	69,40	70,60							
80	79,40	80,60							
90	89,40	90,60							
100	99,30	100,70							

WE'LL BE PLEASED TO ADVISE FOR YOUR APPLICATION.